

## TDM Tizen Manual





## Contents

Welcome to TDM digital signage .....	3
Tizen version .....	3
Functions .....	4
Installation of Tizen app.....	5
Support.....	8

## Welcome to TDM digital signage

Thank you for your interest in TDM digital signage software. TDM is a cloud-based digital signage solution that can be fully managed and configured using your web browser. This manual is designed to assist users in a user-friendly way to install TDM on your computer or screen, and to publish content.

- Minimum system requirements
- Functions
- Installing TDM

Before we begin, we would like to let you know that we will be available to assist you at any time if you encounter any difficulties. We are here for you, regardless of whether you are a new or existing TDM user. Our contact details can be found on our website: <http://www.tdmsignage.com/contact/>

## Tizen version

Minimum system requirements:

- Tizen-compatible
- Recommended minimal space of 4GB
- Recommended memory 1GB
- Wi-Fi or cable internet connection\*

\* A cable connection is recommended for displaying Full HD content.

## Functions

Function	Player-version [PC]	Non-player version [HTML5]	Android version [ANDROID]	Tizen Version
Video upload	V	X	V	V
Youtube	V	V	V	V
PDF integration	V	V	V	V
Powerpoint integration	V	V	V	V
Twitter integration	V	V	V	V
Instagram integration	V	V	V	V
Facebook integration	V	V	V	V
Websites	V	V	V	V
Flash	V	X	X	X
Silverlight	V	X	X	X
Streaming Video	V	V	V	V
Streaming Audio	V	V	V	V
Weather feed	V	V	V	V
Dynamic text	V	V	V	V
External data [RSS/XML]	V	V	V	V
Media RSS	V	V	V	V
TV-channels (only with Sony)	X	V	V	X
Local caching*	V	X	V	V
Ticker tape	V	V	V	V
Plan module (scheduling)	V	V	V	V
Bandwith- efficient**	V	X	V	V
Monitoring	V	V	V	V
RS232 Commandos	V	X	X	X
Touch functionality	V	V	V	V
Interactivity	V	V	V	V
Spectator Statistics ***	V	X	X	X
Offline mode	V	X	V	V

- \*) Local caching is used to retrieve data from the server and save it to the local device, so as to ensure that presentations can still be displayed even when your internet connection is down. Note: this does not apply to services such as audio and video streaming.
- \*\*\*) The player is bandwidth-efficient because the data is retrieved from the TDM servers only once. The player version and Tizen app do not need to retrieve the content from the internet on each separate occasion, making it bandwidth-efficient.
- \*\*\*) For the use of Spectator Statistics you need a full-hd camera, connected to your screen and player. Furthermore you need to download additional software from the download section in the TDM designer. TDM Spectator Statistics licenses can be purchased through your reseller of distributor.

Now that you are aware of the system requirements and know what version you will be using, you are ready to proceed to the next step – installing TDM.

## Installation of Tizen app

After running the default configuration the screen will be set to use MagicInfo. We need to change this to URL Launcher. To do this switch on your Tizen device and press the menu button. In the menu navigate to the System options.





In the settings menu navigate to “Play via” and select URL Launcher. We are now able to configure the TDM App. Press the back button until you are back to the normal input screen.



The Tizen displays require to download an app through a URL Launcher. To enter this URL press the home button. In this menu you should be able to see the option: “URL Launcher - Settings”. Open this option.

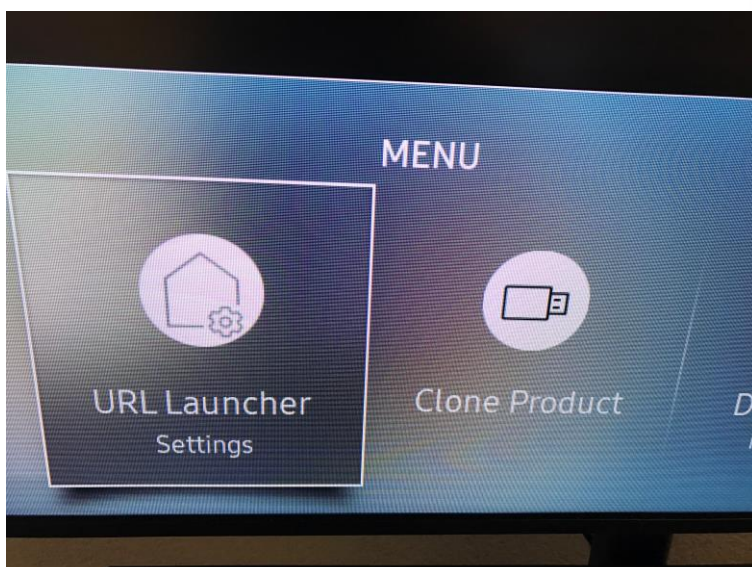

There are two versions available for the Tizen app. One version for landscape mode and one version for portrait. The URLs for the APPs are:

Landscape version: <http://tizen.tdmsignage.com/v1/>

Portrait version: <http://tizen.tdmsignage.com/portrait/>

Enter the corresponding URL at the Install Web App field and select OK.



As soon as you have done so, the display will start downloading and installing the app. Once the app is installed a popup will appear, asking for you license code. You can find this in your Designer; it is the last part of your license-URL. In the example below, it would be “g92onupu”. Fill it out in the field and click Save.

Once you have clicked Save, the app will start looking for content and will show up in your Designer as a player:

### PLAYER OVERVIEW

OVERVIEW PLAYERS

Name	License	Status
HTML player 1 <a href="http://html.tdmsignage.com/g92onupu">http://html.tdmsignage.com/g92onupu</a>	HTML5	<span style="color: red;">●</span> <a href="#">Show player URL</a>

All you need to do now is assign your player to one of your presentations. On page 22 of the TDM Designer manual you can find how to do that.

The status icon will display as green then. Like a PC and HTML5 player license, an Tizen license can only be used on one device.



## Support

After reading this manual, you should be able to install the Tizen app on your Tizen device. Our website also contains answers to Frequently Asked Questions (FAQ).

If you require additional support, we will be pleased to assist you from Monday to Friday from 9:00 a.m. to 5:00 p.m. at telephone number +31 20 2610985 or by e-mail at [support@tdmsignage.nl](mailto:support@tdmsignage.nl).